



PRICED AT
\$429,900

 2779 Sq Ft

 4 Beds

 3.5 Baths

 2 Car Garage

 2.0 Story

Dove Hollow is a family-friendly master-planned community offering an expansive floor plans with ample flex and office space. This amenity rich community is less than 30-minutes from downtown Dallas and will offer a community center, a community park and an abundance of green spaces.

**Want to Know More
About This Home?**

CONTACT OUR COMMUNITY SALES MANAGER

LOGAN CHIPMAN

Call Us @ 214-433-4991

 CENTRE LIVING
HOMES

DOVE HOLLOW
SPARROW PLAN

2,779 SQFT | 4 BED | 3.5 BATH | FLEX ROOM | LOFT | COVERED PATIO | 2-CAR GARAGE



FIRST FLOOR



SECOND FLOOR

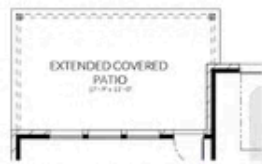

OPT. EXTENDED PATIO



OPT. FIREPLACE

Want to Know More
About This Home?

CONTACT OUR COMMUNITY SALES MANAGER
LOGAN CHIPMAN
Call Us @ 214-433-4991