



PRICED AT  
**\$469,900**

 2779 Sq Ft

 4 Beds

 3.5 Baths

 2 Car Garage

 2.0 Story

Dove Hollow is a family-friendly master-planned community offering an expansive floor plans with ample flex and office space. This amenity rich community is less than 30-minutes from downtown Dallas and will offer a community center, a community park and an abundance of green spaces.

Want to Know More  
About This Home?

CONTACT OUR COMMUNITY SALES MANAGER

LOGAN CHIPMAN

Call Us @ 214-433-4991





2,779 SQFT | 4 BED | 3.5 BATH | FLEX ROOM | LOFT | COVERED PATIO | 2-CAR GARAGE

## DOVE HOLLOW

### SPARROW PLAN



FIRST FLOOR



SECOND FLOOR

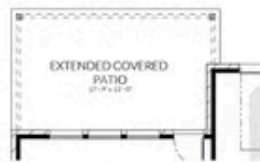

OPT. EXTENDED PATIO



OPT. FIREPLACE

Want to Know More  
About This Home?

CONTACT OUR COMMUNITY SALES MANAGER  
**LOGAN CHIPMAN**  
Call Us @ 214-433-4991