





PRICED AT
\$469,900

 2671 Sq Ft

 4 Beds

 3.5 Baths

 2 Car Garage

 1.0 Story

Dove Hollow is a family-friendly master-planned community offering an expansive floor plans with ample flex and office space. This amenity rich community is less than 30-minutes from downtown Dallas and will offer a community center, a community park and an abundance of green spaces.

Want to Know More
About This Home?

CONTACT OUR COMMUNITY SALES MANAGER

LOGAN CHIPMAN

Call Us @ 214-433-4991



PAINTED TREE
SEQUOIA PLAN



ELEVATION A



ELEVATION A
STONE OPTION



ELEVATION B

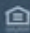

ELEVATION B
STONE OPTION

Centre Living Homes | 4300 MacArthur Ave, Suite 165 | Dallas, TX 75209 | 469.567.3518 | www.centrelivinghomes.com
Centre Living Homes policy of continual attention to design and construction requires that specifications, equipment and dimensions be subject to change without notice. Floor plans are artists renderings. Architectural are pending. 

Want to Know More
About This Home?

CONTACT OUR COMMUNITY SALES MANAGER
LOGAN CHIPMAN
Call Us @ 214-433-4991



PAINTED TREE
SEQUOIA PLAN

2,671 SQFT | 4 BED | 3.5 BATH | STUDY | 3-CAR GARAGE

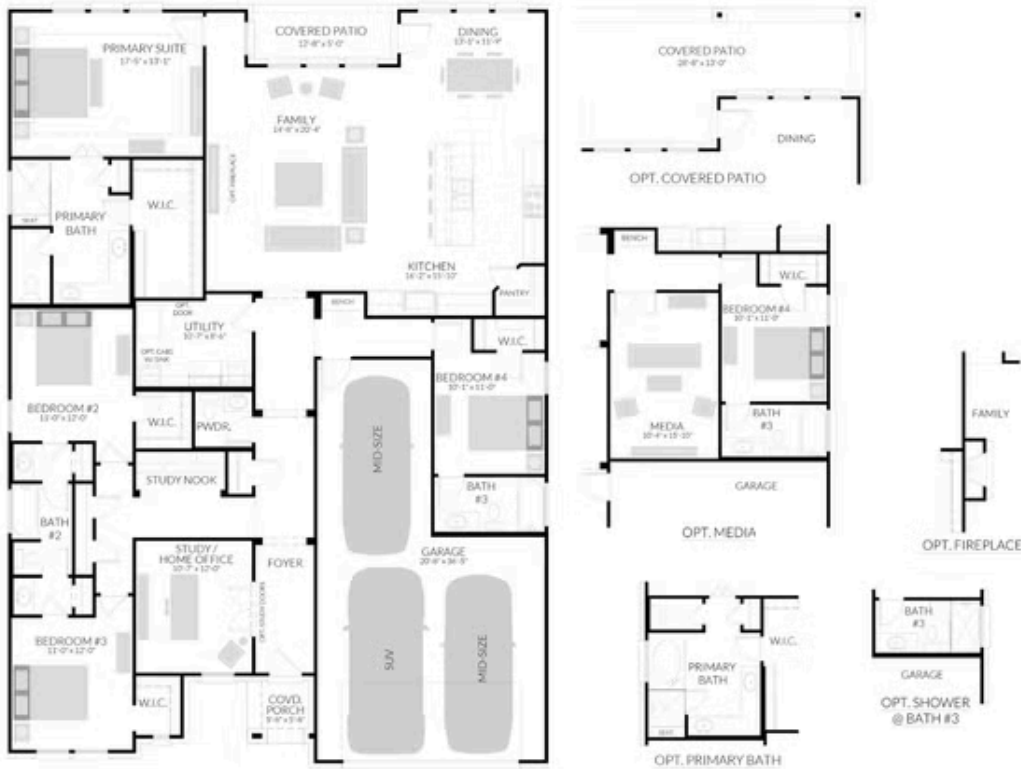

Centre Living Homes policy of continual attention to design and construction requires that specifications, equipment and dimensions be subject to change without notice. floor plans are artists renderings. Architectural are pending.

Want to Know More
About This Home?

CONTACT OUR COMMUNITY SALES MANAGER
LOGAN CHIPMAN
Call Us @ 214-433-4991